

4-9. VOLTMETER, VOLTMETER RELAY, AND GENERATOR 2 RELAY REPLACEMENT (Con't).

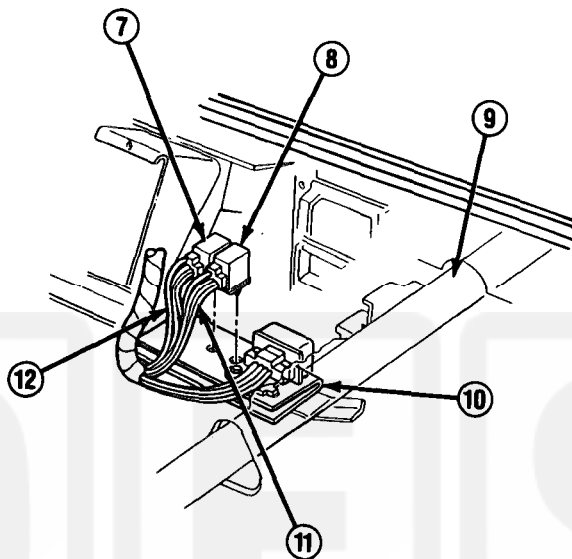

3. Install voltmeter (6) on instrument cluster plate (2). Install retaining bracket (1) with 2 washers (4) and nuts (5).

FOLLOW-ON TASKS:

- Install instrument cluster plate if removed. (See paragraph 4-7)
- Check operation of voltmeter, door ajar light, or generator 2.

TA49868

4-10. SPEEDOMETER CABLE AND ADAPTER REPLACEMENT.

This task covers:

a. Removal

b. Installation

INITIAL SETUP:

Equipment Condition

- Both battery negative cables disconnected.
(See paragraph 4-38)

Materials/Parts

- One seal
-

a. REMOVAL

NOTE

If removing speedometer cable (2), perform steps 1-5.

If removing M1009 speedometer adapter assembly (6), perform steps 4-6.

1. Depress lock (3) and disconnect speedometer cable (2) from back of speedometer (4).
2. Pull speedometer cable (2) through engine compartment bulkhead (1). Remove grommet (11) from engine compartment bulkhead if damaged.
3. Remove nut (9) and clip (10).
4. Loosen nut (8) and disconnect speedometer cable (2) from speedometer adapter assembly (6) or transfer case.
5. Remove seal (7) from speedometer cable (2). Discard seal.
6. Loosen nut (5) and remove speedometer adapter assembly (6).

b. INSTALLATION

NOTE

- If installing M1009 speedometer adapter assembly (6), perform steps 1-3.
- If installing speedometer cable (2), perform steps 2-8.
- M1009 uses a ring-shaped plastic seal (6) inside speedometer adapter nut (5) instead of a seal inside speedometer cable nut (8).

1. Install speedometer adapter assembly (6) by tightening nut (5).
2. Install new seal (7) in speedometer cable (2).
3. Connect speedometer cable (2) to speedometer adapter assembly (6) or transfer case by tightening nut (8).
4. Place clip (10) on speedometer cable (2) and install with nut (9).